



YUASA

PRODUCT

RANGE

OVERVIEW

The world's leading battery manufacturer



From the deep sea to outer space



The GS Yuasa Group consists of 65 subsidiaries and 33 affiliates in countries throughout the world.

Since its founding in 1895, the GS Yuasa Group has continually contributed to economic development and the improvement of living standards through the development and manufacture of batteries, power supply systems and lighting equipment. We are a major force in the market as one of the world's leading manufacturers of automotive and motorcycle batteries. As a supplier of high-performance power supply systems, we help ensure the reliability of social infrastructure.

Responding to today's increasingly sophisticated needs our extensive range of next generation energy system lithium-ion batteries encompasses not only vehicle use but also products in a wide range of fields, from deep sea to aerospace, to meet the ever more sophisticated needs of the times.

Throughout its long history, the GS Yuasa Group has worked to create innovative technology. This commitment serves as the foundation for our continuing efforts to explore new possibilities in the field of electrical energy under a corporate vision expressed in the words "Innovation and Growth."

Yuasa Europe

- 1 Yuasa Battery Europe Limited
Ebbw Vale
- 2 Yuasa Battery Sales (UK) Ltd
Swindon
- 3 Yuasa Battery (Europe) GMBH
Düsseldorf
- 4 Yuasa Battery France SA
Lyon
- 5 Yuasa Italy SRL
Milan
- 6 Yuasa Iberia
Madrid
- Yuasa Battery (UK) Ltd Factory
Ebbw Vale



GS Yuasa are original equipment suppliers to the world's leading vehicle manufacturers.

Automotive & Commercial



Motorcycle & Powersports



Next Generation Automotive Batteries - Micro Hybrid, Hybrid & Electric Vehicles

Yuasa Number	Case Type	Voltage	Capacity at 20-hour Rate (Ah)	Cold Cranking Performance (Amps) EN1	Cell Layout	Terminal	Container Features	Dimensions (mm)			Mean Weight with Acid (kg)	Recommended Charge Rate (Amps)	Handles	End-Venting	State of Charge Indicator	Semi Traction Features
								Length	Width	Height						

YBX9000 AGM START STOP PLUS BATTERIES

YBX9012	L1 DIN AGM	12V	50	520	0	T1	B3	207	175	190	15.9	3	•	•		•
YBX9027	L2 DIN AGM	12V	60	680	0	T1	B3	242	175	190	16.7	4	•	•		•
YBX9096	L3 DIN AGM	12V	70	760	0	T1	B3	278	175	190	19.5	4	•	•		•
YBX9115	L4 DIN AGM	12V	80	800	0	T1	B3	317	175	190	21.9	5	•	•		•
YBX9019	L5 DIN AGM	12V	95	850	0	T1	B3	353	175	190	27	5	•	•		•
YBX9020	L6 DIN AGM	12V	105	950	0	T1	B3	393	175	190	29	6	•	•		•



Features

- Approximately 360,000 starts
- For high specification Start/Stop vehicles
- Absorbed Glass Mat construction with no free acid
- Double lid (Leak/spill proof)
- VRLA
- Integrated flame arrestor
- OE Quality, Performance & Specification

Performance

Compared to Conventional Automotive Batteries

- +150% improved Dynamic Charge Acceptance (DCA)
- +200% increased cyclic durability

AGM



YBX7000 EFB START STOP BATTERIES

YBX7054	B20 JIS EFB (M42)	12V	40	340	0	T1/T3	N	197	128	227	11.5	2				
YBX7055	B20 JIS EFB (M42R)	12V	40	340	1	T1/T3	N	197	128	227	11.5	2				
YBX7053	B24 JIS EFB (N55)	12V	45	370	0	T1/T3	N	238	128	227	13	3				
YBX7027	L2 DIN EFB	12V	60	560	0	T1	B3	242	175	190	16.6	4	•	•	•	
YBX7005	D23 JIS EFB (Q55/Q85)	12V	64	620	0	T1	N	232	173	225	17.5	4				
YBX7014	D23 JIS EFB (Q55R/Q85R)	12V	64	620	1	T1	N	232	173	225	17.5	4				
YBX7100	LB3 DIN EFB	12V	65	650	0	T1	B3	278	175	175	17.4	4	•	•	•	
YBX7096	L3 DIN EFB	12V	70	650	0	T1	B3	278	175	190	19.3	4	•	•	•	
YBX7030	D26 JIS EFB (S85/S95)	12V	72	760	0	T1	N	260	173	225	19.5	4				
YBX7031	D26 JIS EFB (S85R/S95R)	12V	72	760	1	T1	N	260	173	225	19.5	4				
YBX7110	LB4 DIN EFB	12V	75	730	0	T1	B3	317	175	175	20.1	4	•	•	•	
YBX7115	L4 DIN EFB	12V	80	730	0	T1	B3	317	175	190	20.8	5	•	•	•	
YBX7335	D31 JIS EFB (T110)	12V	80	780	0	T1	N	305	173	225	22.5	4				



Features

- Approximately 270,000 starts
- For lower specification Start/Stop vehicles
- Sealed tip/tilt double lid
 - Reduces water loss by up to 30%
 - VDA roll over test compliant*
- High charge acceptance envelope type separators and anti-sulphation technology
- Carbon/Lithium plate additives
- Integrated flame arrestor
- OE Quality, Performance & Specification

Performance

Compared to Conventional Automotive Batteries

- +170% improved Dynamic Charge Acceptance (DCA)
- +100% increased cyclic durability

EFB



*German Association of the Automotive Industry

Auxiliary Batteries and Advanced Battery Fitting System

Yuasa Number	Case Type	Voltage	Capacity at 20-hour Rate (Ah)	Cold Cranking Performance (Amps) EN1	Cell Layout	Terminal	Container Features	Dimensions (mm)			Recommended Charge Rate (Amps)	Handles	End-Venting	State of Charge Indicator	Semi Traction Features
								Length	Width	Height					

YUASA AUXILIARY, BACKUP & SPECIALIST BATTERIES

NP1.2-12	IND AGM	12V	1.2	NA	3	A	N	97	48	54.5	0.6	0.1					•
NP7-12	IND AGM	12V	7	NA	4	A/D	N	151	65	97.5	2.7	1					•
YB4L-B(CP)	MC	12V	4.2	45	0	5	N	120	70	92	1.7	0.4					
YTX4L-BS(CP)	MC AGM	12V	3.2	50	0	5	N	114	71	86	1.6	0.4					•
YTX9-BS(CP)	MC AGM	12V	8.4	135	1	5	N	151	88	106	3	0.9					•
YTX14-BS(CP)	MC AGM	12V	12.6	200	1	5	N	151	88	146	4.6	1.4					•
44B19L	B19 JIS	12V	40	340	0	T1	N	187	127	225	9.5	2					
HJ-LB20L	B20 JIS AGM (R33 Skyline)	12V	35	272	0	T3	N	198	130	202	10.5	2			•		•
HJ-LD26L	D26 JIS AGM (R33/4 Skyline)	12V	55	450	0	T1	N	260	173	202	18	4			•		•
HJ-A24L	A24 JIS AGM (MX5)	12V	40	310	0	T1	N	238	129	187	10.7	2					•
HJ-S34B20L	B20 JIS AGM	12V	35	272	0	T3	N	197	129	227	10.5	2			•		•
HJ-S34B20L-A	B20 JIS AGM	12V	35	272	0	T3	N	197	129	227	10.5	2			•	•	•
HJ-S34B20R	B20 JIS AGM	12V	35	272	1	T3	N	197	129	227	10.5	2			•		•
HJ-S46B24R	B24 JIS AGM	12V	46	310	1	T3	N	238	129	227	12.7	3			•		•



Features

- 9 AGM auxiliary batteries
- 2 Flooded auxiliary batteries
- 3 AGM starter batteries

Fitment examples

- Toyota, Honda & Lexus Hybrids
- Mercedes E & S Class
- Volvo DRiVe
- BMW 7 series
- Mitsubishi & PSA Electric Vehicle

Advanced Battery Fitting System

With the introduction of new CO₂ production control systems such as smart charging and Idle Start/Stop (ISS) it is essential that vehicles have the correct battery type and specification installed.

Combining the Yuasa Yu-Fit tool and the powerful Yuasa online fitting system gives installers the complete battery replacement solution for modern start-stop & micro hybrid vehicles.

<http://batterylookup.yuasa.co.uk/>

- Battery selection by VRM lookup*
- Battery location information
- Estimated fitting time
- Detailed step by step workshop fitting instructions
- Yu-Fit tool for battery to vehicle registration in under 5 minutes
- Always up-to-date with the latest vehicles

*unavailable in some countries



THE WORLD'S LEADING BATTERY MANUFACTURER

YUASA

Your Vehicle

BMW 5 520 d Diesel

Yu-Fit Required: Yes
 Note 1: OK battery is AGM. Only replace with AGM battery.
 Equipment: Start-stop function. Brake energy recovery.
 Body type: Saloon

Yuasa - YBX9019
 AGM Start-Stop Plus Battery

- Capacity (20hr): 95 Ah
- Starting Power - CCA (EN): 850 Amps
- Estimated fitting time: 30 minutes
- Dimensions (mm): L- 953, W- 175, H- 190
- Battery location: Luggage compartment

CAUTION
 Only fit to the correct vehicle.
 Only fit AGM battery.

RSP (Price includes VAT)
£235.95 (€284.95)

[View fitting information](#)

Conventional Automotive Batteries

Yuasa Number	Case Type	Voltage	Capacity at 20-hour Rate (Ah)	Cold Cranking Performance (Amps) EN1	Cell Layout	Terminal	Container Features	Dimensions (mm)			Mean Weight with Acid (kg)	Recommended Charge Rate (Amps)	Handles	End-Venting	State of Charge Indicator	Semi Traction Features
								Length	Width	Height						

YBX5000 SILVER HIGH PERFORMANCE SMF BATTERIES

YBX5053	B24 JIS	12V	48	430	0	T1/T3	N	238	129	223	12.1	3	•	•	•
YBX5057	B24 JIS	12V	48	430	1	T1/T3	N	238	129	223	12.1	3	•	•	•
YBX5063	LB1 DIN	12V	50	480	0	T1	B3/B4	207	175	175	12.1	3	•	•	•
YBX5012	L1 DIN	12V	52	480	0	T1	B3	207	175	190	13.7	4	•	•	•
YBX5075	LB2 DIN	12V	60	620	0	T1	B3/B4	243	175	175	14.4	4	•	•	•
YBX5027	L2 DIN	12V	62	620	0	T1	B3/B4	243	175	190	16.1	4	•	•	•
YBX5005	D23 JIS	12V	65	550	0	T1	N	232	175	225	15.7	4	•	•	•
YBX5100	LB3 DIN	12V	75	680	0	T1	B3/B4	278	175	175	17.3	4	•	•	•
YBX5096	L3 DIN	12V	80	760	0	T1	B3	278	175	190	18.8	4	•	•	•
YBX5110	LB4 DIN	12V	85	800	0	T1	B3	317	175	175	19.4	5	•	•	•
YBX5334	D31 JIS	12V	95	830	1	T1	B1	303	174	222	21.9	5	•	•	•
YBX5335	D31 JIS	12V	95	830	0	T1	B1	303	174	222	21.9	5	•	•	•
YBX5019	L5 DIN	12V	100	900	0	T1	B3	353	175	190	23.4	6	•	•	•
YBX5020	L6 DIN	12V	110	900	0	T1	B3	393	175	190	26.7	6	•	•	•



Features

- Approximately 50,000 starts
- Sealed tip/tilt double lid
 - Reduces water loss by up to 30%
 - VDA roll over test compliant*
- Calcium/Calcium plates
- State of Charge Indicator (SOI)
- Integrated carrying handle & flame arrestor
- OE Quality, Performance & Specification

Performance

- Up to 35% increase in cranking power**

*German Association of the Automotive Industry **YBX1063 350 CCA YBX5063 480 CCA

YBX3000 SMF BATTERIES

YBX3009	B17 JIS	12V	30	280	0	T3	N	167	127	224	8.6	2	•	•	•
YBX3054	B19 JIS	12V	36	330	0	T1/T3	N	187	127	223	9	2	•	•	•
YBX3055	B19 JIS	12V	36	330	1	T1/T3	N	187	127	223	9	2	•	•	•
YBX3056	B19 JIS	12V	36	330	0	T1/T3	B1	187	137	225	9	3	•	•	•
YBX3202	L0 DIN	12V	40	360	0	T1	B3	175	175	190	10.5	2	•	•	•
YBX3102	L0 DIN	12V	40	360	1	T1	B3	175	175	190	10.5	2	•	•	•
YBX3077	L1 DIN	12V	45	380	1	T1	B3	207	175	190	11.8	3	•	•	•
YBX3053	B24 JIS	12V	45	400	0	T1/T3	N	238	129	223	11.4	3	•	•	•
YBX3057	B24 JIS	12V	45	400	1	T1/T3	N	238	129	223	11.4	3	•	•	•
YBX3063	LB1 DIN	12V	45	425	0	T1	B3/B4	207	175	175	11.5	3	•	•	•
YBX3012	L1 DIN	12V	50	420	0	T1	B3	207	175	190	12.2	3	•	•	•
YBX3008	D20 JIS	12V	50	450	0	T1	N	202	173	225	12.8	3	•	•	•
YBX3004	D20 JIS	12V	50	450	1	T1	N	202	173	225	12.8	3	•	•	•
YBX3108	D20 JIS	12V	50	400	0	T1	B1	202	173	225	12.8	3	•	•	•
YBX3111	GR58 BCI	12V	50	530	0	T1	B1	236	182	178	12.9	4	•	•	•
YBX3113	GR58 BCI	12V	50	530	1	T1	B1	236	182	178	12.9	4	•	•	•
YBX3065	LB2 DIN	12V	56	500	0	T1	B3/B4	243	175	175	13.7	4	•	•	•
YBX3005	D23 JIS	12V	60	450	0	T1	N	232	175	225	14.9	4	•	•	•
YBX3014	D23 JIS	12V	60	450	1	T1	N	232	175	225	14.9	4	•	•	•
YBX3075	LB2 DIN	12V	60	550	0	T1	B3/B4	243	175	175	13.9	4	•	•	•
YBX3027	L2 DIN	12V	60	550	0	T1	B3/B4	243	175	190	14.8	4	•	•	•

Yuasa Number	Case Type	Voltage	Capacity at 20-hour Rate (Ah)	Cold Cranking Performance (Amps) EN1	Cell Layout	Terminal	Container Features	Dimensions (mm)			Mean Weight with Acid (kg)	Recommended Charge Rate (Amps)	Handles	End-Venting	State of Charge Indicator	Semi Traction Features
								Length	Width	Height						

YBX3000 SMF BATTERIES continued

YBX3078	L2 DIN	12V	60	550	1	T1	B3	243	175	190	14.8	4	•	•	•
YBX3030	D26 JIS	12V	70	570	0	T1	N	260	174	225	17.3	4	•	•	•
YBX3031	D26 JIS	12V	70	570	1	T1	N	260	174	225	17.3	4	•	•	•
YBX3068	D26 JIS	12V	70	570	0	T1	B9	269	174	225	17.3	4	•	•	•
YBX3069	D26 JIS	12V	70	570	1	T1	B9	269	174	225	17.3	4	•	•	•
YBX3100	LB3 DIN	12V	71	650	0	T1	B3/B4	278	175	175	15.8	4	•	•	•
YBX3096	L3 DIN	12V	75	650	0	T1	B3	278	175	190	18	4	•	•	•
YBX3086	L3 DIN	12V	75	650	1	T1	B3	278	175	190	18	4	•	•	•
YBX3110	LB4 DIN	12V	80	720	0	T1	B3	317	175	175	18.3	4	•	•	•
YBX3335	D31 JIS	12V	90	700	0	T1	B1	303	174	222	20.8	4	•	•	•
YBX3334	D31 JIS	12V	90	700	1	T1	B1	303	174	222	20.8	4	•	•	•
YBX3017	LB5 DIN	12V	90	800	0	T1	B3	353	175	175	21.2	6	•	•	•
YBX3019	L5 DIN	12V	95	850	0	T1	B3	353	175	190	22.5	6	•	•	•



Features

- Approximately 30,000 starts
- Sealed tip/tilt double lid
 - Reduces water loss by up to 30%
 - VDA roll over test compliant*
- Calcium/Calcium plates
- Integrated carrying handle & flame arrestor
- State of Charge Indicator (SOC)
- OE Quality, Performance & Specification

Performance

- Up to 20% increase in cranking power**

*German Association of the Automotive Industry **YBX1063 350 CCA YBX3063 425 CCA

YBX1000 CaCa BATTERIES

YBX1038	A (British Leyland)	12V	35	330	1	T1	B12	239	133	206	11.1	2			
YBX1063	LB1 DIN	12V	40	350	0	T1	B3/B4	207	175	175	10.8	2	•	•	
YBX1012	L1 DIN	12V	45	380	0	T1	B3	207	175	190	11.8	3	•	•	
YBX1048	E2 (Talbot)	12V	45	350	0	T1	B1	220	135	225	13	3			
YBX1049	E2 (Talbot)	12V	45	350	1	T1	B1	220	135	225	13	3			
YBX1065	LB2 DIN	12V	54	470	0	T1	B3/B4	243	175	175	13.6	4	•	•	
YBX1027	L2 DIN	12V	55	480	0	T1	B3/B4	243	175	190	14.2	5	•	•	
YBX1072	D26 T-Lid (Volvo)	12V	70	570	1	T1	N	265	175	205	19.2	4	•	•	
YBX1096	L3 DIN	12V	70	620	0	T1	B3	278	175	190	17.2	5	•	•	
YBX1100	LB3 DIN	12V	70	620	0	T1	B3/B4	278	175	175	15.8	4	•	•	
YBX1017	LB5 DIN	12V	85	770	0	T1	B3	353	175	175	20.5	6	•	•	



Features

- Approximately 20,000 starts
- Remote flame arrestor*
- Central venting*

- Integrated carrying handle*
- Calcium/Calcium plates
- OE Quality, Performance & Specification

*Excludes 038, 048 & 049

Commercial Vehicle, PSV, Agricultural and Plant Batteries

Yuasa Number	Case Type	Voltage	Capacity at 20-hour Rate (Ah)	Cold Cranking Performance (Amps) EN1	Cell Layout	Terminal	Container Features	Dimensions (mm)			Mean Weight with Acid (kg)	Recommended Charge Rate (Amps)	Handles	End-Venting	State of Charge Indicator	Semi Traction Features
								Length	Width	Height						

CARGO DEEP CYCLE BATTERIES (GM) - GLASS MAT SEPARATORS

727GM	DIN A GM	12V	140	815	3	T1	N	513	189	223	37.7	8	•			•
723GM	DIN B GM	12V	185	1100	4	T1	N	513	223	223	46.9	10	•			•
729GM	DIN B GM	12V	185	1100	3	T1	N	513	223	223	46.9	10	•			•
732GM	DIN C GM	12V	220	1400	3	T1	N	513	272	242	60.6	12	•			
724GM	DIN C GM	12V	230	1200	4	T1	N	518	273	242	59.6	12	•			•
725GM	DIN C GM	12V	230	1200	3	T1	N	518	273	242	59.6	12	•			•



Features

- Increased service life over SHD
- Ultimate deep cycle capabilities
- Glass mat separators*
- Vibrolock plate fixing*
- Vibration Resistant - V3 (EN50342.1 A1 2011)
- OE Quality, Performance & Specification

*Improved resistance to vibration and deep cycle capabilities over HD and SHD

CARGO SUPER HEAVY DUTY BATTERIES (SHD)

640SHD	GR31 BCI	12V	115	1000	9	T1	N	329	171	240	26.2	5	•	•	•	
663SHD	Euro Compact Low D2	12V	115	800	0	T1	N	345	172	232	25	6	•			
664SHD	Euro Compact Low D2	12V	115	800	1	T1	N	345	172	232	25	6	•			
665SHD	Euro Compact Low D2A	12V	115	800	0	T1	B1	345	172	232	29.5	6	•			
627SHD	DIN A	12V	143	900	3	T1	N	513	189	223	39	8	•			
622SHD	MAC 143	12V	150	930	3	T1	N	510	216	209	39.2	8	•			
629SHD	DIN B	12V	180	1050	3	T1	N	513	223	223	44	10	•			
625SHD	DIN C	12V	220	1150	3	T1	N	513	272	242	57.2	12	•			



Features

- Advanced plate design
- Increased service life over HD
- Deep cycle capabilities
- Vibration Resistant - V2 (EN50342.1 A1 2011)
- OE Quality, Performance & Specification

Performance

- Up to 30% increase in cranking power over Cargo HD*

*629HD 815 CCA v 629SHD 1050 CCA

Yuasa Number	Case Type	Voltage	Capacity at 20-hour Rate (Ah)	Cold Cranking Performance (Amps) EN1	Cell Layout	Terminal	Container Features	Dimensions (mm)			Mean Weight with Acid (kg)	Recommended Charge Rate (Amps)	Handles	End-Venting	State of Charge Indicator	Semi Traction Features
								Length	Width	Height						

CARGO HEAVY DUTY BATTERIES (HD)

643HD	Euro Compact Low D2	12V	96	620	0	T1	N	345	172	232	26	5	•			
644HD	Euro Compact Low D2	12V	96	620	1	T1	N	345	172	232	26	5	•			
640HD	GR31 BCI	12V	100	900	9	T1	N	329	171	240	24.8	5	•	•	•	
663HD	Euro Compact Low D2	12V	105	735	0	T1	N	345	172	232	27.6	6	•			
664HD	Euro Compact Low D2	12V	105	735	1	T1	N	345	172	232	27.6	6	•			
616HD	E41 JIS	12V	110	650	0	T1	N	407	174	231	29.6	6	•			
618HD	E41 JIS	12V	110	650	1	T1	N	407	174	231	29.6	6	•			
627HD	DIN A	12V	120	675	3	T1	N	513	189	223	33.6	6	•			
655HD	Euro Compant High D3	12V	125	720	0	T1	N	345	172	283	34	7	•			
656HD	Euro Compact High D3	12V	125	720	1	T1	N	345	172	283	34	7	•			
615HD	MAC 110 Kamina	12V	135	910	3	T1	B3	514	175	210	32.5	8	•	•	•	
622HD	MAC 143	12V	135	880	3	T1	N	510	216	209	38	7	•			
633HD	-	12V	135	735	6	T1	B1	360	253	240	40.8	7	•			
638HD	-	12V	140	1050	0	T1	B1	508	175	205	36.5	8	•			
628HD	DIN A	12V	143	900	4	T1	N	513	189	223	39	8	•			
630HD	DIN A	12V	143	900	3	T1	B3	513	189	223	39	8	•			
629HD	DIN B	12V	155	815	3	T1	N	513	223	223	42	8	•			
620HD	DIN B	12V	180	1050	3	T1	B3	513	223	223	44	9	•			
623HD	DIN B	12V	180	1050	4	T1	N	513	223	223	44	8	•			
626HD	DIN B	12V	180	1050	4	T1	B3	513	223	223	44	9	•			
624HD	DIN C	12V	200	1050	4	T1	N	513	273	242	55	11	•			
625HD	DIN C	12V	200	1050	3	T1	N	513	272	242	55	11	•			



Features

- Advanced plate design
- Deep cycle capabilities
- Vibration Resistant - V2 (EN50342.1 A1 2011)
- OE Quality, Performance & Specification

Leisure, Marine and Garden Machinery Batteries

Yuasa Number	Case Type	Voltage	Capacity at 20-hour Rate (Ah)	Cold Cranking Performance (Amps) EN1	Cell Layout	Terminal	Container Features	Dimensions (mm)			Mean Weight with Acid (kg)	Recommended Charge Rate (Amps)	Handles	End-Venting	State of Charge Indicator	Semi Traction Features
								Length	Width	Height						

LEISURE BATTERIES

L26-70	GR24 BCI	12V	70	450	1	T1	B5	260	174	225	17	4	•	•	•	
L26-80	GR24 BCI	12V	80	540	1	T1	B5	260	174	225	18	4	•	•	•	
L35-90	Euro Compact Low Kamina	12V	90	640	1	T1	N	350	174	224	23.6	5	•	•	•	
L35-100	Euro Compact Low Kamina	12V	100	700	1	T1	N	350	174	224	24.7	5	•	•	•	
L35-115	Euro Compact Low Kamina	12V	115	750	1	T1	N	350	174	224	25.4	6	•	•	•	
L36-100	L5 DIN	12V	100	700	0	T1	B3	353	175	190	22.5	5	•	•	•	



Features

- Caravan/leisure use
- Long storage life
- Deep cycle
- State of Charge Indicator (SOCi)
- Enhanced safety venting
- Integrated flame arrestor

MARINE BATTERIES

M26-80	GR24 BCI	12V	80	450	1	TM	B5	260	174	225	18.9	4	•	•	•	•
M27-90	GR27 BCI	12V	90	720	1	TM	B1	304	173	225	21.2	5	•	•	•	•
M31-100	GR31 BCI	12V	100	600	1	TM	N	330	173	240	23.5	5	•	•	•	•



Features

- Marine & leisure craft use
- Dual terminal
- Sealed lid (Leak/spill proof tip-tilt)
- Vibrolock plate fixing*
- Deep cycle
- 45° tilt angle
- State of Charge Indicator (SOCi)
- Enhanced safety venting
- Integrated flame arrestor

*Improved resistance to vibration

GARDEN BATTERIES

895	A19 JIS	12V	26	200	0	T4	N	187	127	181	7.5	2				
896	A19 JIS	12V	26	200	1	T4	N	187	127	181	7.5	2				
U1R	U1 BCI	12V	30	270	0	T4	N	187	127	181	7.8	2	•			
U1	U1 BCI	12V	30	270	1	T4	N	187	127	181	7.8	2	•			
897		18V	897 Robotic Lawnmower Battery (Ni-Mh 15*2.2Ah)													



Features

- Powered gardening equipment use
- Ride on mowers etc.

Classic 6V Vehicle Batteries

Pro-Spec Deep Cycle Batteries

Yuasa Number	Case Type	Voltage	Capacity at 20-hour Rate (Ah)	Cold Cranking Performance (Amps) EN1	Cell Layout	Terminal	Container Features	Dimensions (mm)			Mean Weight with Acid (kg)	Recommended Charge Rate (Amps)	Handles	End-Venting	State of Charge Indicator	Semi Traction Features
								Length	Width	Height						

CLASSIC 6V VEHICLE BATTERIES

404	-	6V	77	360	0	T1	B12	218	170	190	12.7	4				
421	-	6V	56	250	0	T1	N	162	173	224	11.5	3				
451	-	6V	180	700	0	T1	N	412	175	225	31.2	12				
501	-	6V	85	385	0	T1	N	225	175	220	20.1	5				
511	-	6V	105	425	0	T1	N	225	175	225	23.8	7				
521	-	6V	112	400	0	T1	N	291	172	223	22.5	7				
531	-	6V	135	630	0	T1	N	319	175	230	23	8				
541	-	6V	150	510	0	T1	N	348	172	216	27	9				
702	-	6V	200	520	0	T9	N	311	184	365	39.5	12	•			
703	-	6V	260	690	0	T9	N	368	184	368	48	16	•			
712	-	6V	200	520	0	T1	N	311	184	365	39.5	12	•			
713	-	6V	260	690	0	T1	N	368	184	368	48	15	•			
722	-	6V	200	665	0	T9	N	422	176	260	35	12	•		•	
733	-	6V	200	665	0	T1	N	422	176	243	35	12	•		•	



Features

- Deep cycle capability
- Vibration resistant hard rubber case
- OE Quality, Performance & Specification

Type	Capacity				Dimensions (mm)				Weight (kg)
	@25A (Mins)	@75A (Mins)	5HR (Ah)	20HR (Ah)	Length	Width	Height	THA	

PRO-SPEC BATTERIES - Floor Cleaners, Access Platforms and Golf Buggies

DCB105-6(ET)	Deep Cycle 6V Battery	447	115	185	225	259	179	245	276	28.6
DCB125-6(ET)	Deep Cycle 6V Battery	488	132	195	240	259	179	245	276	30.7
DCB145-6(ET)	Deep Cycle 6V Battery	530	145	215	260	259	179	264	295	33.0
DCB605-6(ET)	Deep Cycle 6V Battery	383	105	175	210	259	179	245	276	27.0
DCB8125-8(ET)	Deep Cycle 8V Battery	425	110	190	240	262	181	283	316	37.6
DCB875-8(ET)	Deep Cycle 8V Battery	295	75	145	170	262	181	245	276	29.0
DCB890-8(ET)	Deep Cycle 8V Battery	340	90	155	190	262	181	245	276	31.6
DCB1275-12(ET)	Deep Cycle 12V Battery	290	70	125	150	329	181	245	276	37.5

Accessory

23295513 Yuasa Pro-Spec Carrying Handle



Features

- Deep cycle
- Easy maintenance vent caps
- Glass Mat/porous rubber separator*
- Three terminal types available
- Special lid/case design**
- Enhanced life cycle over competitors

Fitment examples

- Electric vehicles (golf carts/mobility)
- Warehouse equipment (fork lifts/access platforms)

*Resists corrosion and reduces electrical resistance **Prevents short circuits from active material shedding

Automotive Battery Accessories, Battery Cell Assembly Layout, Hold-Down and Container Features

AUTOMOTIVE BATTERY ACCESSORIES

23288996	Hold Down Adaptors (Pair) - Convert from B3 to B4
23292114	Terminal Adaptor Pack - DIN (T1) to Ford Cargo (T8)
23294630	Terminal Adaptor Pack - JIS (T3) to DIN (T1)
23294631	Terminal Adaptor Pack - DIN (T1) to Ford (T4)

CELL ASSEMBLY LAYOUT

6 Volt

12 Volt

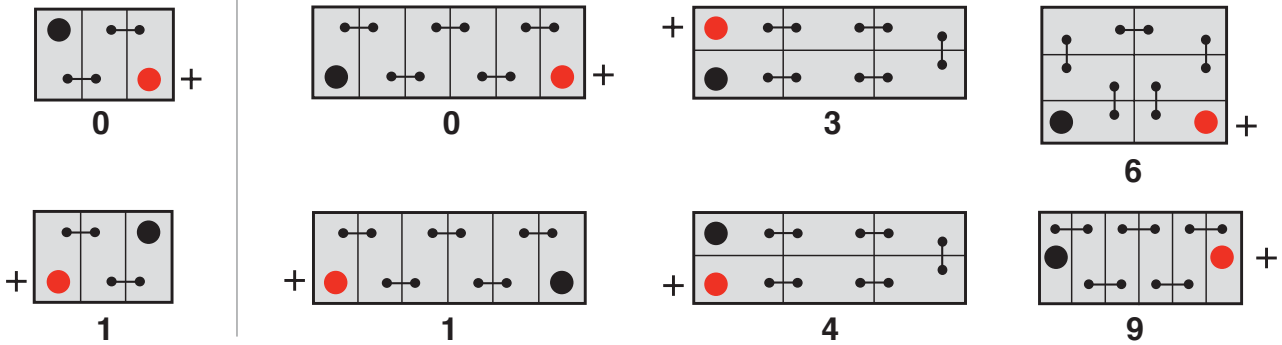

BATTERY HOLD-DOWN & CONTAINER FEATURES

(Dimensions in millimetres)

N

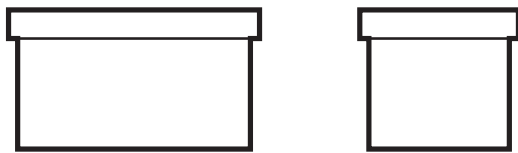

B1

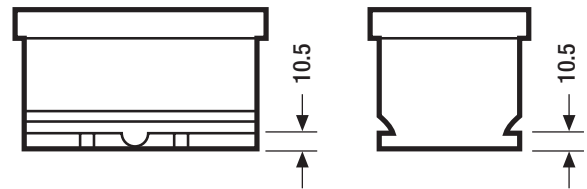

B3

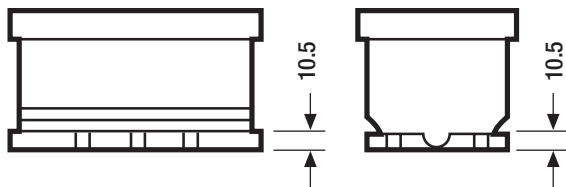

B5

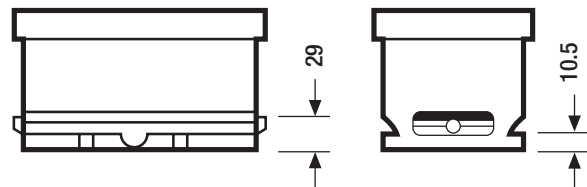

B3/B4 (B3 with Hold-Down adaptor 23288996)

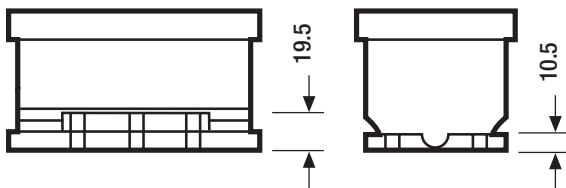

B9

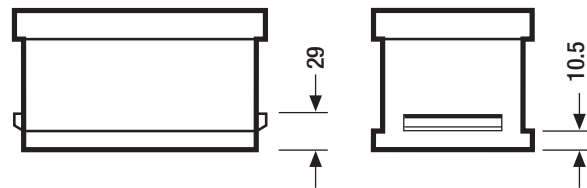

B12

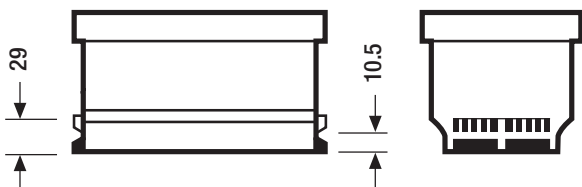

Automotive Terminal Configurations

(Dimensions in millimetres)

T1
Standard DIN Post

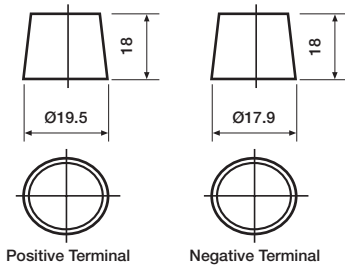

T3
Small Japanese
JIS Terminal

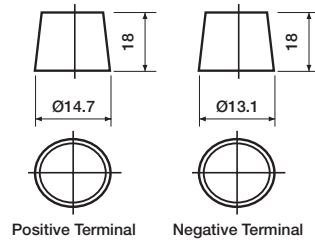

T4-F

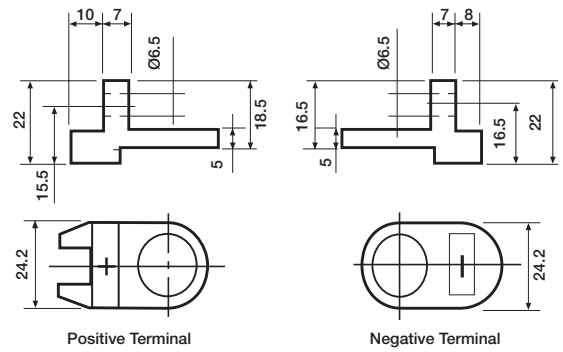

T4

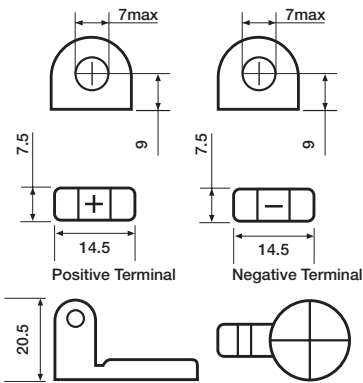

5



T9
Classic 702/703/721/722

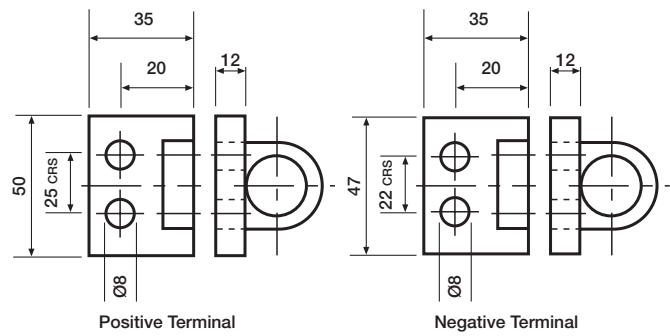

T8
Ford Cargo Terminal use adapter kit
(order 23292114)

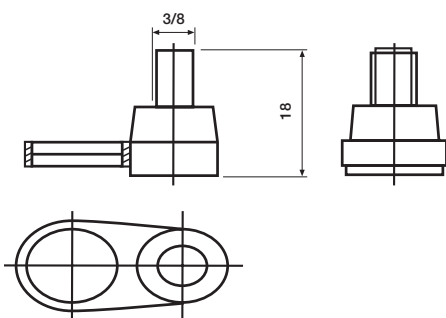

A
Faston tab:187

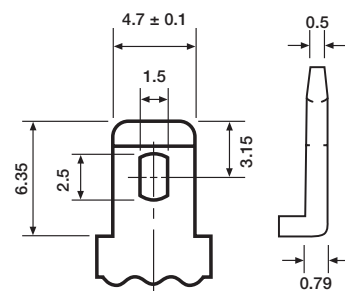

A/D
Faston tab:250

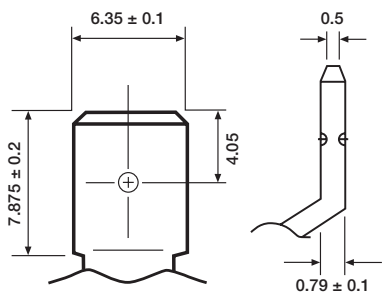

TM
Marine Dual Terminals

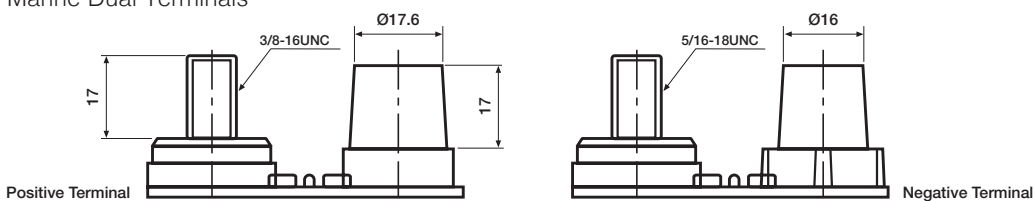

Motorcycle & Powersports Batteries



MAINTENANCE FREE HIGH PERFORMANCE

If high power is top priority in a replacement battery, look to Yuasa's High Performance Maintenance Free batteries. Yuasa means more power, less maintenance and longer life. Yuasa's High Performance Maintenance Free batteries are your best choice for motorcycles, utility vehicles, scooters, ATVs, riding mowers, personal watercraft and snowmobiles.

All of the features of a Standard Maintenance Free

PLUS Increased Power – Up to 30% more cranking amps thanks to a radial grid design and additional plates



MAINTENANCE FREE VRLA

VRLA (Valve Regulated Lead Acid) means a battery that's perfect for people who have better things to do than battery maintenance! Our permanently sealed VRLA battery never needs refilling; however, it still needs periodic charging. Ideal for motorcycles, scooters, ATVs, riding mowers and personal watercraft.

- **Spill-proof design** means virtually no possibility of leaks
- **Advanced lead-calcium technology** pumps up starting power
- **Sulphation retardant** dramatically reduces battery-killing plate sulphation
- **Long lasting** which means Yuasa's High Performance Maintenance Free batteries will last up to three times longer than conventional batteries
- **Exceptional resistance to vibration** makes Yuasa the most reliable battery on the market today
- **And, VRLA batteries hold voltage** longer and need less charging in standby or storage mode



YUMICRON CX

For increased power, less maintenance and longer life, YuMicron CX is the battery of choice. The first motorcycle battery built on lead-calcium technology, YuMicron CX is specially designed for today's big, complex vehicles, where higher cranking power is a must. It delivers all the features of the standard YuMicron – plus...

- **Unique CX design** for higher cold cranking amps
- **Lead-calcium technology** reduces water loss – and servicing – by 66% compared to lead antimony
- **And, CX substantially reduces self-discharge** – for longer time between charges

YUMICRON

Personal watercraft, snowmobiles and ATVs make special demands – and YUASA's YuMicron Battery meets them head-on. The high-tech, power-boosting design also makes YuMicron ideal for accessory-laden touring bikes and modified vehicles.

- **Heavy duty glass mat** resists vibration damage
- **Special thin Separator** packs in extra plates, delivers up to 30% more cranking power than conventional types
- **Through-the-wall intercell connector** minimises internal resistance, maximises power
- **Sulphate Stop** curbs plate sulphation – and provides longer life

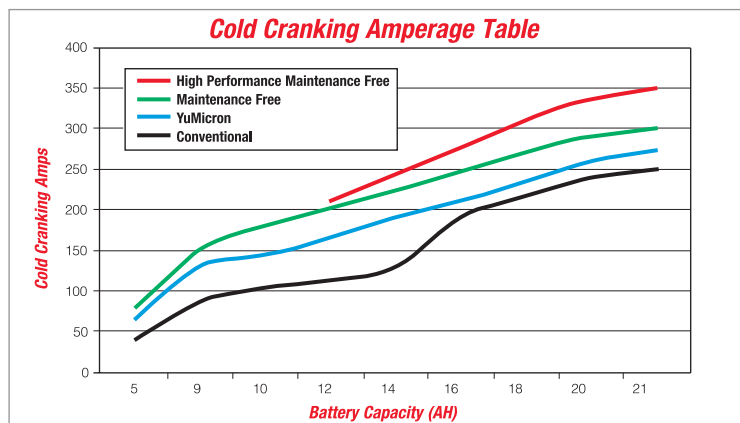

Superior High Rate Performance

The electrically low resistant separator and heavy duty plates allow the Yuasa VRLA batteries to yield 30% more and faster starting power over conventional batteries.

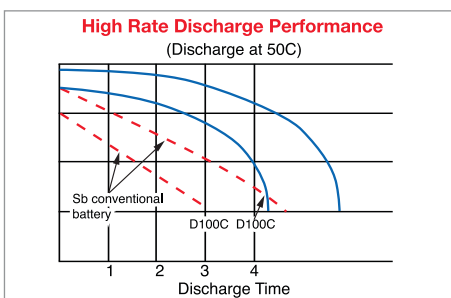

Shelf Life

The special plate material and the dry-charge construction enable the storage for nearly 2 years without noticeable loss of charge retention.

Lowest Self-Discharge

The calcium grid reduces the self-discharge rate to only 0.2% a day against 0.5-1.0% for conventional batteries.

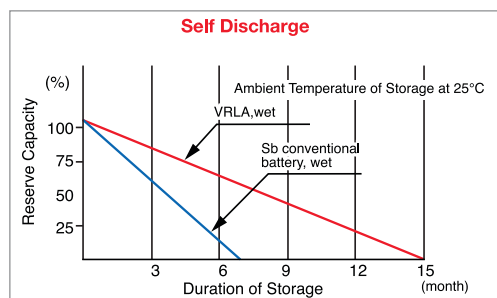

Toughness

Even if the batteries are left discharged for considerably long periods, a simple recharge will help restore full charge.

Motorcycle & Powersports Batteries continued

Battery Type	Note	Pack Type	Capacity Ah (10-HR)	Capacity Ah (20-HR)	Dimensions - mm (±2mm)			Weight with acid (kg)	Acid volume (Litre)	Charge current (Amps)	CCA* @ -18°C	Terminal Type (refer to page 20)	Assembly Figure
					Length	Width	Height						

HIGH PERFORMANCE MAINTENANCE FREE

YTX14AH-BS	(ii)	CP	12	12.6	134	89	166	4.9	0.66	1.2	210	4
YTX14AHL-BS		CP	12	12.6	134	89	166	4.9	0.66	1.2	210	4
YTX14H-BS		CP	12	12.6	150	87	145	4.8	0.69	1.2	240	4
YTX20CH-BS		CP	18	18.9	150	87	161	6.1	0.82	1.8	270	4
YTX20H-BS		CP	18	18.9	175	87	155	6.3	0.93	1.8	310	4
YTX20HL-BS		CP	18	18.9	175	87	155	6.3	0.93	1.8	310	4
YTX20HL-BS-PW	(i)	CP	18	18.9	175	87	175	6.3	0.93	1.8	310	4
YTX24HL-BS		CP	21	22.1	205	87	162	7.9	0.99	2.1	350	4
YTZ5S		CP/WC	3.5	3.7	113	70	85	1.6	N/A	0.4	65	5
YTZ6V		CP	5	5.3	113	70	105	2.0	N/A	0.5	90	5
YTZ7S		WC	6	6.3	113	70	105	2.1	N/A	0.6	130	5
YTZ10S		WC	8.6	9.1	150	87	93	3.2	N/A	0.9	190	11
YTZ12S		WC	11	11.6	150	87	110	3.7	N/A	1.1	210	11
YTZ14S		WC	11.2	11.8	150	87	110	3.9	N/A	1.1	230	11
GYZ16H		WC	16	16.8	150	87	145	5.6	N/A	1.6	240	5
GYZ20L		WC	20	21.1	175	87	155	6.9	N/A	2.0	250	4
GYZ20H		WC	20	21.1	175	87	155	7.1	N/A	2.0	310	14
GYZ20HL		WC	20	21.1	175	87	155	7.1	N/A	2.0	310	14
YIX30L		WC	30	31.6	166	126	175	9.9	N/A	3.0	385	5
YIX30L-PW	(iii)	WC	30	31.6	166	126	175	9.9	N/A	3.0	385	5
YIX30L-BS		CP	30	31.6	166	126	175	9.9	1.40	3.0	385	5
YIX30L-BS-PW	(iii)	CP	30	31.6	166	126	175	9.9	1.40	3.0	385	5



MAINTENANCE FREE

YTR4A-BS		CP	2.3	2.4	114	49	86	1.1	0.14	0.3	45	12
YT4B-BS		CP	2.3	2.4	114	39	86.5	1.1	0.12	0.3	40	13
YT4L-BS		CP	3	3.2	114	71	86	1.6	0.18	0.4	40	5
YTX4L-BS		CP	3	3.2	114	71	86	1.4	0.18	0.4	50	5
YT5A		WC	5	5.3	121	62	131	2.0	N/A	0.5	70	6
YTX5L-BS		CP	4	4.2	114	71	106	2.0	0.24	0.5	80	5
YT6A		WC	6	6.3	121	62	131	2.2	N/A	0.6	80	6
YT7B-BS		CP/WC	6.5	6.8	150	65	93	2.7	0.33	0.7	110	11
YTX7A-BS		CP	6	6.3	150	87	94	2.6	0.33	0.7	105	5
YTX7L-BS		CP	6	6.3	114	71	131	2.5	0.33	0.6	100	5
YT9B-BS		CP/WC	8	8.4	150	70	105	3.4	0.4	0.8	120	11
YTX9-BS		CP	8	8.4	150	87	105	3.0	0.4	0.9	135	5
YT12A-BS		CP/WC	10	10.5	150	87	105	3.5	0.5	1.0	175	11
YT12B-BS		CP/WC	10	10.5	150	69	130	4.1	0.5	1.0	210	11
YTX12-BS		CP	10	10.5	150	87	130	4.2	0.6	1.2	180	5
YT14B-BS		CP/WC	12	12.6	150	70	145	4.6	0.6	1.2	210	11
YTX14-BS		CP	12	12.6	150	87	145	4.6	0.69	1.4	200	5
YTX14L-BS		CP	12	12.6	150	87	145	4.6	0.69	1.4	200	5
YTX15L-BS		CP	13	13.7	175	87	130	4.8	0.69	1.3	230	4
YTX16-BS		CP	14	14.7	150	87	161	5.3	0.78	1.4	230	4
YTX16-BS-1		CP	14	14.7	150	87	161	5.3	0.78	1.4	230	1
YTX20A-BS		CP	17	17.9	150	87	161	6.0	0.82	1.7	270	4
YTX20-BS		CP	18	18.9	175	87	155	6.7	0.93	1.8	270	4
YTX20L-BS		CP	18	18.9	175	87	155	6.7	0.93	1.8	270	4
YT19BL-BS		CP	17.7	19	186	82	171	5.7	0.95	1.9	170	10

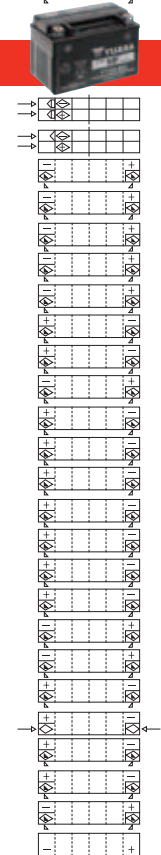

(i) Includes 20mm spacer required when replacing YB16CL-B.
(ii) Includes 10mm spacer required when replacing YB14A-A1 and YB14A-A2.
(iii) Includes 17mm spacer to fit all BRP (Sea-Doo) 1500cc 4-stroke models year 2003 and up.
* CCA (Cold Cranking Amps) rating is for reference only. CCA is a theoretically calculated value. Actual performance may vary due to test conditions.
DC = dry charged (contains 1 battery, acid not included)
CP = combipack (contains 1 battery and 1 acid pack)
WC = wet charged (contains 1 battery acid filled and charged)

Battery Type	Note	Pack Type	Capacity Ah (10-HR)	Capacity Ah (20-HR)	Dimensions - mm (±2mm)			Weight with acid (Kg)	Acid volume (Litre)	Charge current (Amps)	CCA* @ -18°C	Terminal Type (refer to page 20)	Assembly Figure
					Length	Width	Height						

YUMICRON CX



YB16-B-CX		DC	19	20.0	175	100	155	6.3	1.2	1.9	255	6	
YB16HL-A-CX		DC	19	20.0	175	100	155	6.3	1.2	1.9	255	6	
Y50-N18L-A-CX		DC	20	21.1	205	90	162	7.4	1.4	2	260	7	

YUMICRON



YB2.5L-C		DC	2.5	2.6	80	70	105	1.0	0.24	0.3	15	-	
YB2.5L-C-1		DC	2.5	2.6	80	70	105	1.0	0.24	0.3	15	-	
YB2.5L-C-2		DC	2.5	2.6	81	71	106	1.0	0.24	0.3	15	-	
YB3L-A		DC	3	3.2	98	56	110	1.3	0.24	0.3	30	6	
YB3L-B		DC/CP	3	3.2	98	56	110	1.3	0.24	0.3	30	6	
YB4L-A		DC	4	4.2	120	70	92	1.5	0.3	0.4	45	5	
YB4L-B		DC/CP	4	4.2	120	70	92	1.5	0.3	0.4	45	5	
YB5L-B		DC/CP	5	5.3	120	60	130	2.0	0.36	0.5	60	6	
YB6L-B		DC	6	6.3	138	72.5	100	2.1	0.4	0.6	65	6	
YB7-A		DC/CP	8	8.4	135	75	133	3.0	0.6	0.8	105	6	
YB7B-B		DC/CP	7	7.4	150	60	130	3.1	0.5	0.7	80	6	
YB7C-A		DC/CP	7	7.4	130	90	114	3.0	0.6	0.8	75	3	
YB7L-B		DC/CP	8	8.4	135	75	133	2.9	0.6	0.8	75	6	
YB7L-B2		DC	8	8.4	135	75	133	2.9	0.6	0.8	75	4	
YB9A-A		DC	9	9.5	135	75	155	3.1	0.6	0.9	115	6	
YB9L-A2		DC/CP	9	9.5	135	75	139	3.1	0.6	0.9	100	2	
YB9-B		DC/CP	9	9.5	135	75	139	3.1	0.6	0.9	115	6	
YB9L-B		DC	9	9.5	135	75	139	3.1	0.6	0.9	115	6	
YB10A-A2		DC	11	11.6	135	90	155	4.0	0.8	1.1	120	8	
YB10L-A2		DC/CP	11	11.6	135	90	145	4.2	0.8	1.1	120	8	
YB10L-B		DC/CP	11	11.6	135	90	145	4.0	0.8	1.1	120	6	
YB10L-BP		DC	12	12.6	135	90	145	4.0	0.8	1.1	165	6	
YB10L-B2		DC	11	11.6	135	90	145	4.0	0.8	1.1	120	8	
YB12A-A		DC/CP	12	12.6	134	80	160	4.1	0.8	1.2	150	6	
YB12A-AK		DC	10	10.5	134	80	160	3.5	0.8	1.0	165	6	
YB12AL-A		DC	12	12.6	134	80	160	4.0	0.75	1.2	150	6	
YB12AL-A2	(i)	DC/CP	12	12.6	134	80	160	4.0	0.75	1.2	150	8	
YB12A-B		DC/CP	12	12.6	134	80	160	4.0	0.75	1.2	150	6	
YB12B-B2		DC	11	11.6	160	90	130	4.0	0.8	1.2	140	8	
YB12C-A		DC	12	12.6	134	80	175	4.3	0.8	1.2	150	4	
YB14-A2		DC/CP	14	14.7	134	89	166	4.6	0.9	1.4	175	8	
YB14-B2		DC/CP	14	14.7	134	89	166	4.6	0.9	1.4	175	8	
YB14A-A1		DC	14	14.7	134	89	176	4.5	0.9	1.4	175	6	
YB14A-A2		DC/CP	14	14.7	134	89	176	4.5	0.9	1.4	175	8	
YB14L-A		DC	14	14.7	134	89	166	4.6	0.9	1.4	190	6	
YB14L-A1		DC	14	14.7	134	89	166	4.6	0.9	1.4	175	1	
YB14L-A2		DC/CP	14	14.7	134	89	166	4.6	0.9	1.4	175	8	
YB14L-B2		DC/CP	14	14.7	134	89	166	4.6	0.9	1.4	175	8	
SYB14L-A2		DC	14	14.7	134	89	166	4.6	0.9	1.4	175	8	
SYB14L-B2		DC	14	14.7	134	89	166	4.6	0.9	1.4	175	8	
YB16AL-A2		DC/CP	16	16.8	207	71.5	164	5.3	1.1	1.6	210	2	
HYB16A-AB		DC	16	16.8	151	91	180	5.0	0.9	1.6	210	7	

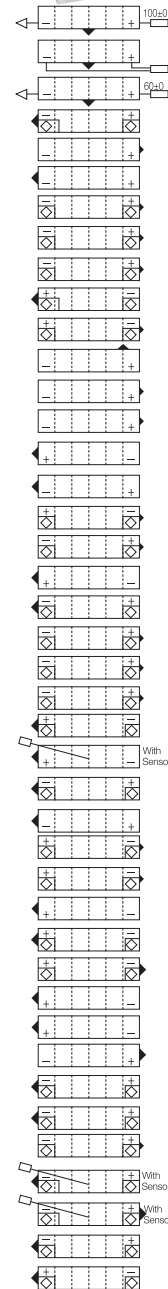

(i) Includes a terminal adaptor for converting to top mount.

* CCA (Cold Cranking Amps) rating is for reference only. CCA is a theoretically calculated value. Actual performance may vary due to test conditions.

DC = dry charged (contains 1 battery, acid not included)

CP = combipack (contains 1 battery and 1 acid pack)

WC = wet charged (contains 1 battery acid filled and charged)

Motorcycle & Powersports Batteries continued

Battery Type	Note	Pack Type	Capacity Ah (10-HR)	Capacity Ah (20-HR)	Dimensions - mm (±2mm)			Weight with acid (kg)	Acid volume (Litre)	Charge current (Amps)	CCA* @ -18°C	Terminal Type (refer to page 20)	Assembly Figure
					Length	Width	Height						

YUMICRON continued

YB16-B		DC/CP	19	20.0	175	100	155	6.3	1.2	1.9	215	6	
YB16L-B		DC/CP	19	20.0	175	100	155	6.3	1.2	1.9	215	6	
YB16B-A		DC	16	16.8	160	90	161	5.1	1.0	1.6	207	4	
YB16B-A1		DC/CP	16	16.8	160	90	161	5.1	1.0	1.6	207	7	
YB16C-B		DC	19	20.0	175	100	175	6.1	1.2	1.9	240	5	
YB16CL-B		DC/CP	19	20.0	175	100	175	6.1	1.2	1.9	240	5	
YB18-A		DC	18	18.9	180	90	162	5.8	1.2	1.8	215	7	
YB18L-A		DC/CP	18	18.9	180	90	162	5.8	1.2	1.8	215	7	
Y50-N18A-A		DC	20	21.1	205	90	176	6.5	1.5	2.0	240	7	
Y50-N18L-A		DC	20	21.1	205	90	162	7.4	1.4	2.0	240	7	
Y50-N18L-A3		DC	20	21.1	205	90	162	7.4	1.4	2.0	240	4	
SY50-N18L-AT		DC/CP	20	21.1	205	90	162	6.5	1.4	2.0	240	7	
Y60-N24-A		DC	28	29.5	184	124	175	8.6	1.7	2.8	241	3	
Y60-N24L-A		DC/CP	28	29.5	184	124	175	8.6	1.7	2.8	241	3	
YB30L-B		DC	30	31.6	168	132	176	8.5	1.7	3.0	300	4	
YB30CL-B		DC	30	31.6	168	132	192	8.8	1.7	3.0	300	4	
51814	**	DC/CP	-	18.0	186	82	171	5.6	1.0	1.9	100	10	
51913	**	DC/CP	-	19.0	186	82	171	5.6	1.0	1.9	100	10	
52015	**	DC	-	20.0	186	82	171	5.6	1.0	2.0	110	10	
52515	**	DC/CP	-	25.0	186	130	171	8.4	1.8	2.5	130	10	
53030	**	DC/CP	-	30.0	186	130	171	9.4	1.6	3.0	180	10	



CONVENTIONAL 12 Volt

12N5-3B		DC/CP	5	5.3	120	60	130	2.0	0.4	0.5	35	6	
12N5-4B		DC	5	5.3	120	60	130	2.0	0.4	0.5	39	6	
12N5.5-3B		DC/CP	5.5	5.8	135	60	130	2.5	0.4	0.6	55	6	
12N5.5-4A		DC	5.5	5.8	135	60	130	2.5	0.4	0.6	55	2	
12N5.5-4B		DC	5.5	5.8	138	61	131	2.5	0.4	0.6	55	6	
12N5.5A-3B		DC/CP	5.5	5.8	103	90	114	2.4	0.5	0.6	55	6	
12N7-3B		DC/CP	7	7.4	135	75	133	3.0	0.5	0.7	70	6	
12N7-4A		DC/CP	7	7.4	135	75	133	3.0	0.5	0.7	70	6	
12N7-4B		DC	7	7.4	135	75	133	3.0	0.5	0.7	70	6	
12N7B-3A		DC	7	7.4	151	61	131	2.9	0.5	0.7	70	6	
12N7D-3B		DC	7	7.4	135	75	150	2.9	0.6	0.7	70	6	
12N9-3A		DC	9	9.5	135	75	139	3.3	0.6	0.9	80	9	
12N9-3B		DC/CP	9	9.5	135	75	139	3.2	0.6	0.9	85	6	
12N9-4B-1		DC/CP	9	9.5	135	75	139	3.2	0.6	0.9	85	6	
12N10-3A		DC/CP	10	10.5	135	90	145	3.9	0.8	1.0	100	6	
12N10-3A-1		DC	10	10.5	135	90	145	3.9	0.8	1.0	100	6	
12N10-3A-2		DC	10	10.5	135	90	145	3.9	0.8	1.0	100	8	
12N10-3B		DC/CP	10	10.5	136	91	146	3.9	0.8	1.0	100	6	
12N11-3A-1		DC	11	11.6	135	90	155	3.6	0.8	1.1	109	8	
12N11-3B		DC	11	11.6	135	90	155	3.6	0.8	1.1	109	6	
12N12-3B		DC	12	12.6	202	76	134	4.4	0.8	1.2	108	6	
12N12A-4A-1		DC/CP	12	12.6	134	80	160	3.7	0.7	1.2	120	6	
12N14-3A		DC/CP	14	14.7	134	89	166	4.5	0.8	1.4	125	8	
12N18-3		DC	18	18.9	205	90	162	6.5	1.3	1.8	140	6	
12N24-3A		DC	24	25.3	184	124	175	7.9	1.8	2.4	200	3	
12N24-3		DC	24	25.3	184	124	175	7.9	1.8	2.4	200	3	
12N24-4		DC/CP	24	25.3	184	124	179	7.6	1.6	2.4	190	3	
YHD-12		DC	29	29.5	206	133	165	8.3	2.2	2.8	200	9	



* CCA (Cold Cranking Amps) rating is for reference only. CCA is a theoretically calculated value. Actual performance may vary due to test conditions.

** CCA values as mentioned are based on the DIN standard and are for reference only.

DC = dry charged (contains 1 battery, acid not included)

CP = combipack (contains 1 battery and 1 acid pack)

WC = wet charged (contains 1 battery acid filled and charged)

Battery Type	Note	Pack Type	Capacity Ah (10-HR)	Capacity Ah (20-HR)	Dimensions - mm (±2mm)			Weight with acid (Kg)	Acid volume (Litre)	Charge current (Amps)	CCA* @ -18°C	Terminal Type (refer to page 20)	Assembly Figure
					Length	Width	Height						

CONVENTIONAL 6 Volt



6N2-2A		DC	2	2.1	70	47	96	0.5	0.1	0.2		-	
6N2-2A-1		DC	2	2.1	70	47	96	0.5	0.1	0.2		-	
6N2-2A-3		DC	2	2.1	70	47	96	0.5	0.1	0.2		-	
6N2-2A-4		DC	2	2.1	70	47	96	0.5	0.1	0.2		-	
6N2-2A-8		DC	2	2.1	70	47	96	0.5	0.1	0.2		-	
6N2-2A-9		DC	2	2.1	70	47	96	0.5	0.1	0.2		-	
6N2A-2C		DC	2	2.1	70	47	106	0.5	0.1	0.2		-	
6N2A-2C-1		DC	2	2.1	70	47	106	0.5	0.1	0.2		-	
6N2A-2C-3		DC	2	2.1	70	47	106	0.5	0.1	0.2		-	
6N2A-2C-4		DC	2	2.1	70	47	106	0.5	0.1	0.2		-	
6N4-2A		DC	4	4.2	71	71	96	0.8	0.2	0.4		-	
6N4-2A-2		DC	4	4.2	71	71	96	0.8	0.2	0.4		-	
6N4-2A-3		DC	4	4.2	71	71	96	0.8	0.2	0.4		-	
6N4-2A-4		DC	4	4.2	71	71	96	0.8	0.2	0.4		-	
6N4-2A-5		DC	4	4.2	71	71	96	0.8	0.2	0.4		-	
6N4-2A-7		DC	4	4.2	71	71	96	0.8	0.2	0.4		-	
6N4-2A-8		DC	4	4.2	71	71	96	0.8	0.2	0.4		-	
6N4-2A-9		DC	4	4.2	71	71	96	0.8	0.2	0.4		-	
6N4-2A-12		DC	4	4.2	71	71	96	0.8	0.2	0.4		-	
6N4A-4D		DC	4	4.2	61	57	131	1.0	0.2	0.4		-	
6N4B-2A		DC	4	4.2	102	48	96	1.0	0.2	0.4		-	
6N4B-2A-3		DC	4	4.2	102	48	96	1.0	0.2	0.4		-	
6N4B-2A-4		DC	4	4.2	102	48	96	1.0	0.2	0.4		-	
6N4B-2A-5		DC	4	4.2	102	48	96	1.0	0.2	0.4		-	
6N4C-1B		DC	4	4.2	71	71	105	0.8	0.2	0.4		-	
6N5.5-1D		DC	5.5	5.8	90	70	100	1.1	0.3	0.6		-	
6N6-1B		DC	6	6.3	99	57	111	1.2	0.3	0.6		-	
6N6-3B		DC	6	6.3	99	57	111	1.3	0.3	0.6		6	
6N6-3B-1		DC/CP	6	6.3	99	57	111	1.3	0.3	0.6		6	
6N6-1D		DC	6	6.3	99	57	111	1.2	0.3	0.6		-	
6N6-1D-2		DC	6	6.3	99	57	111	1.2	0.3	0.6		-	
B39-6		DC	7	7.4	126	48	126	1.7	0.3	0.7		6	
B49-6		DC/CP	8	8.4	91	83	161	2.1	0.5	0.8		6	
6N11-2D		DC	11	11.6	150	70	100	2.0	0.4	1.1		6	
6N11A-1B		DC	11	11.6	122	62	131	2.1	0.4	1.1		6	
6N11A-3A		DC/CP	11	11.6	122	62	131	2.1	0.4	1.1		6	
6N11A-4		DC	11	11.6	122	62	131	2.1	0.4	1.1		6	
6N12A-2C		DC	12	12.6	156	57	116	2.0	0.5	1.2		9	
B54-6		DC	12	12.6	156	57	116	2.3	0.5	1.2		6	
6N12A-2D		DC	12	12.6	156	57	116	2.3	0.45	1.2		6	
B38-6A		DC	13	13.7	119	83	161	2.9	0.62	1.3		6	
6YB8L-B		DC	8	8.4	120	70	95	1.6	0.31	0.8		6	
6YB11-2D		DC	11	11.6	150	70	100	2.0	0.4	1.1		6	

* CCA (Cold Cranking Amps) rating is for reference only. CCA is a theoretically calculated value. Actual performance may vary due to test conditions.

DC = dry charged (contains 1 battery, acid not included)

CP = combipack (contains 1 battery and 1 acid pack)

WC = wet charged (contains 1 battery acid filled and charged)

Motorcycle & Powersports Terminal Configurations

Terminal shapes vary from one battery to another. By identifying the correct replacement battery from the listing in this book, you are assured of the proper terminal configuration. For custom applications, refer to the following chart to identify terminal shape and corresponding batteries.

Type	Terminal Shape			Battery Type					
	Front	Side	Top						
1				YB14L-A1	YTX16-BS-1				
2				YB9L-A2	YB16AL-A2	12N5.5-4A			
3				Y60-N24-A	12N24-3	12N24-3A	YB7C-A	12N24-4	
4				YB12C-A YTX14L-BS YTX20CH-BS YTX20HL-BS-PW	YB16B-A YTX14AH-BS YTX20-BS YTX24HL-BS	Y50-N18L-A3 YTX14AHL-BS YTX20L-BS GYZ20L	YB30L-B YTX14H-BS YTX20H-BS YTX16-BS	YB30CL-B YTX15L-BS YTX20HL-BS	
5				YTZ3 YTX5L-BS YTX12-BS YB4L-B	YTZ5S YTX7A-BS YTX14-BS YB16C-B	YTZ6 YTX7L-BS YTX20A-BS YB16CL-B	YTZ7S YTX9-BS YIX30L	YTX4L-BS YT12A-BS YB4L-A	
6				YB3L-A YB7B-B YB10L-B YB14A-A1 YB16HL-A-CX 12N5.5-4B 12N9-3B 12N18-3 6N11-2D B39-6	YB3L-B YB7L-B YB10L-BP YB14L-A 12N5-3B 12N7-3B 12N9-4B-1 6N6-3B 6N12A-2D B49-6	YB5L-B YB9A-A YB12A-A YB16-B 12N5-4B 12N7-4A 12N10-3B 6N6-3B-1 6YB8L-B B54-6	YB6L-B YB9-B YB12A-B YB16-B-CX 12N5.5-3B 12N7-4B 12N10-3B-A 6N11A-1B 6YB11-2D	YB7-A YB9L-B YB12AL-A YB16L-B 12N5.5A-3B 12N7D-3B 12N12A-4A-1 6N11A-3A B38-6A	
7				HYB16A-AB Y50-N18L-A SY50-N18L-AT	YB16B-A1** Y50-N18L-A2	YB18-A Y50-N18L-A-CX	YB18L-A SY50-N18L-A	Y50-N18A-A	
8				YB10A-A2 YB14-A2 YB14-B2	YB10L-A2 YB14A-A2 YB14L-B2	YB10L-B2 YB14L-A2 12N10-3A-2	YB12AL-A2* SYB14L-A2 12N11-3A-1	YB12B-B2 SYB14L-B2 12N14-3A	
9				YHD-12	6N12A-2C	12N9-3A			
10				51814	52015	51913	52515	53030	
11				YT7B-BS YTZ12S	YT9B-BS YTZ14S	YT12B-BS	YT14B-BS	YTZ10S	
12				YTR4A-BS					
13				YT4B-BS					
14				GYZ20H	GYZ20HL				

** Includes terminal adaptor for converting to side mount. * Includes terminal adaptor for converting to top mount.



Features

- World's number one powersports battery
- 100% vehicle parc coverage
- Exact fit not 'will-fit'
- Original Equipment for all major Motorcycle, ATV, Jet Ski and Snowmobile manufacturers

Battery Testers, Analysers and Chargers

YUASA TESTERS & BATTERY ANALYSERS

MDX117	Yuasa MDX117 Bike Tester
MDX617	Yuasa MDX617 Tester (without printer)
MDX617P	Yuasa MDX617P Tester (with printer)
MDX627P	Yuasa MDX627P Tester and Electrical System Analyser (with printer)
MDXPRINT	Yuasa MDX Tester Printer Roll
Yu-Fit	Yuasa Yu-Fit Battery Configuration Tool



Configuration Tool

New technology micro hybrid vehicles equipped with emission control systems may require replacement battery configuration. Battery configuration can be carried out using the new Yuasa Yu-Fit battery configuration tool. Combining the Yuasa Yu-Fit and the powerful Yuasa online fitting system, gives installers the complete battery replacement solution for modern start-stop & micro hybrid vehicles.



Analysers

Yuasa's range of automotive and motorcycle battery analysers ensure the most up-to-date and accurate test results. A custom made solution that enables potential cost savings and increased revenues. Test more batteries and sell more batteries.

YUASA SMART CHARGERS & ACCESSORIES

YCX08A12 (E)	YCX0.8 12V 0.8A Yuasa 6-Stage Smart Charger (UK or Euro Plug)
YCX08A6 (E)	YCX0.8 6V 0.8A Yuasa 4-Stage Smart Charger (UK or Euro Plug)
YCX5A12 (E)	YCX5.0 12V 5A Yuasa 8-Stage Smart Charger (UK or Euro Plug)
YCX10A12 (E)	YCX10 12V 10A Yuasa 8-Stage Smart Charger (UK or Euro Plug)
YCX25A12L (E)	YCX25L 12V 25A Yuasa Workshop Charger, 6m Cable & Mount (UK or Euro Plug)
YCXCONM6	Comfort Connector Lead - 0.4m Cable with M6 Eyelet
YCXLEDM6	LED Charge Indicator - 0.55m Cable with M6 Eyelet



Features

- Intelligent (SMART) charging
- Reverse connection protection
- Spark proof connection
- Safe on-vehicle charging
- Suitable for new technology batteries*
- Up to 8 charging phases

*AGM and EFB

Yu-Power CHARGERS

YPC09A12MC	Yu-Power 900ma 12V Motorcycle Battery Charger, UK Plug
YPC2A6	Yu-Power 2A 6V Charger - UK/Euro Plug c/w YPCCLIPMC
YPC2A12	Yu-Power 2A 12V Charger - UK/Euro Plug c/w YPCCLIPMC
YPC4A12	Yu-Power 4A 12V Charger - UK/Euro Plug c/w YPCCLIP
YPC4A24	Yu-Power 4A 24V Charger - UK/Euro plug c/w YPCCLIP
YPC8A12	Yu-Power 8A 12V Charger - UK/Euro Plug c/w YPCCLIP
YPCCLIP	Yu-Power 24" Cordset (Torberry to clips)
YPCCLIPMC	Yu-Power 24" Cordset (std trailer to clips)
YPCMOB	Yu-Power 6" Cordset (male mobility plug to Torberry)
YPCPK	Yu-Power 24" Cordset (Powakaddy to Torberry)
YPCRINGMC	Yu-Power 24" Fused Ring Cordset (std trailer to rings)
YPCTESTMC	Yu-Power LED Battery Tester (trailer plug c/w YPCRINGMC)



Yu-Power™ intelligent chargers utilise multi stage proportional timing technology to ensure safe and efficient charging of lead acid batteries. The use of proportional timing during the bulk charging mode ensures the best balance of maximum state of charge, without damaging the battery before switching to the float charging mode. Once in float charge mode the charger will charge the battery and maintain it at 100% state of charge whilst using an ECO mode to save power.

Industrial Batteries

Part Number	Voltage	Capacity Ah (20hr)*	Capacity Ah (10hr)*	Length (mm)	Width (mm)	Height (mm)	Overall height (mm)	Typical Mass (kg)	Terminal Type		
									Faston -Quick fit/ release (mm)	Female Threaded	Lug Type



YUASA NP SERIES BATTERIES

NP1-6	6	1	0.93	51	42.5	-	54.5	0.25	4.75	-	-
NP1.2-6	6	1.2	1.1	97	25	-	54.5	0.31	4.75	-	-
NP2.8-6	6	2.8	2.5	134	34	-	64	0.57	4.75	-	-
NP4-6	6	4	3.7	70	47	-	105.5	0.87	4.75	-	-
NP7-6	6	7	6.5	151	34	-	97.5	1.32	4.75	-	-
NP10-6	6	10	9.2	151	50	-	97.5	1.93	4.75	-	-
NP12-6	6	12	11.1	151	50	-	97.5	2.05	6.35	-	-
NP0.8-12	12	0.8	0.74	96	25	61.5	-	0.35	-	-	-
NP1.2-12	12	1.2	1.1	97	48	-	54.5	0.58	4.75	-	-
NP1.2-12FR	12	1.2	1.1	97	48	-	54.5	0.58	4.75	-	-
NP2-12	12	2	1.86	150	20	89	-	0.7	4.75	-	-
NP2.1-12	12	2.1	1.9	178	34	-	64	0.82	4.75	-	-
NP2.3-12	12	2.3	2.1	178	34	-	64	0.95	4.75	-	-
NP2.7-12	12	2.7	2.48	79	55	-	106	1.1	4.75	-	-
NP2.8-12	12	2.8	2.5	134	67	-	64	1.12	4.75	-	-
NP3.2-12	12	3.2	2.9	134	67	-	64	1.2	4.75	-	-
NP3.2-12FR	12	3.2	2.9	134	67	-	64	1.2	4.75	-	-
NP4-12	12	4	3.7	90	70	-	106	1.75	4.75	-	-
NP7-12	12	7	6.4	151	65	-	97.5	2.2	4.75	-	-
NP7-12FR	12	7	6.4	151	65	-	97.5	2.2	4.75	-	-
NP7-12L	12	7	6.4	151	65	-	97.5	2.2	6.35	-	-
NP7-12LFR	12	7	6.4	151	65	-	97.5	2.2	6.35	-	-
NP12-12	12	12	11.1	151	98	-	97.5	4.05	6.35	-	-
NP12-12FR	12	12	11.1	151	98	-	97.5	4.05	6.35	-	-
NP17-12I	12	17	15.7	181	76	167	-	6.1	-	M5	-
NP17-12IFR	12	17	15.7	181	76	167	-	6.1	-	M5	-
NP18-12B	12	18	16	180	76	167	-	6.2	-	-	5mm
NP24-12	12	24	22.3	166	175	125	-	9.0	-	M5	-
NP38-12	12	38	35.3	197	165	170	-	14.2	-	M5	-
NP65-12	12	65	60.5	350	166	174	-	23.0	-	M6	-



YUASA NPL SERIES BATTERIES

NPL24-12	12	24	21.12	166	175	125	-	9.0	-	M5	-
NPL24-12FR	12	24	21.12	166	175	125	-	9.0	-	M5	-
NPL38-12	12	38	33.44	197	165	170	-	14.0	-	M5	-
NPL38-12FR	12	38	33.44	197	165	170	-	14.0	-	M5	-
NPL65-12	12	65	57.2	350	166	174	-	23.0	-	M6	-
NPL65-12FR	12	65	57.2	350	166	174	-	23.0	-	M6	-
NPL78-12FR	12	78	68.64	380	166	174	-	27.5	-	M8	-
NPL100-12	12	100	88	407	172	240	-	39.0	-	-	10mm
NPL130-6FR	6	130	114.4	350	166	174	-	23.0	-	M6	-
NPL200-6	6	200	176	398	176	250	-	39.0	-	-	10mm

*to 1.75 Volts per Cell at 20°C

Part Number	Voltage	Capacity Ah (20hr)*	Capacity Ah (10hr)*	Length (mm)	Width (mm)	Height (mm)	Overall height (mm)	Typical Mass (kg)	Terminal Type		
									Faston -Quick fit/ release (mm)	Female Threaded	Torque (Nm)



YUASA REC SERIES BATTERIES

REC10-12	12	10.00	9.00	151	65	112	115.5	3.20	6.35	-	-
REC12-12	12	12.00	11.00	151	98	94	97.5	4.20	6.35	-	-
REC14-12	12	13.00	11.60	151	98	94	97.5	4.20	6.35	-	-
REC22-12	12	22.00	19.70	181	76.2	-	167	6.20	-	M5	2.0-3.0
REC26-12	12	26.00	23.50	166	175	125	-	6.10	-	M5	2.0-3.0
REC36-12	12	36.00	32.00	196	130	158	169	11.20	-	M5	2.0-3.0
REC50-12	12	50.00	40.00	197	165	-	175	15.30	-	M5	2.0-3.0
REC80-12	12	80.00	74.00	259	168	212.5	212.5	27.00	-	M6	3.9-5.4

*to 1.75 Volts per Cell at 20°C

CONNECTORS & ACCESSORIES

Part Number	Description
PK36	Powakaddy Adaptor for REC36-12/YPC33-12
PK22Y	Powakaddy Adaptor for YPC22-12
PK26	Powakaddy Adaptor for REC26-12/YPC26-12
PK22	Powakaddy Adaptor for REC22-12
GB12210	Battery Carry Bag (suitable 17/18/22Ah models)
GB12260	Battery Carry Bag (suitable 24/26Ah models)
GB12360	Battery Carry Bag (suitable 33/36Ah models)
TORB1	Torbury Connector for M5/M6 terminal

YUASA REC GOLF & MOBILITY RANGE

Now available with individual retail packaging:
REC14-12, REC22-12,
REC 26-12 & REC36-12





Yuasa Battery Europe Ltd

Cat. No. April 2015 LIT017
E. & O. E.

www.yuasaeurope.com